

vtech®

Instruction Manual

Disney

Go!Go!
SmartWheels®

Mickey Mouse Café



INTRODUCTION

Thank you for purchasing the **Go! Go! Smart Wheels® - Disney Mickey Mouse Café**. Take Mickey Mouse and the Food Truck on a ride to pick up food and make deliveries, triggering the three **SmartPoint®** locations along the way. Plus, turn the chef's hat, spin the gears, open and close the door and windows, and move the elevator up and down for even more sensory play.

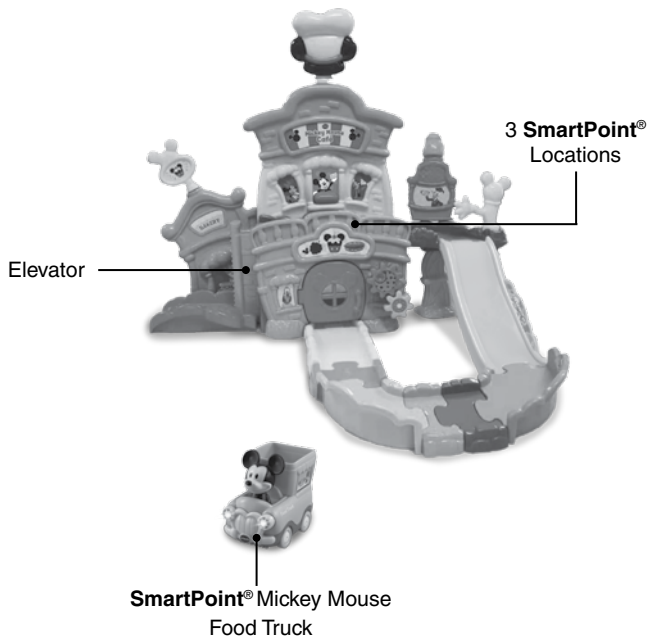

INCLUDED IN THE PACKAGE



One **SmartPoint**[®]
Mickey Mouse Food Truck



One chef's hat



One castle roof



One rotary sign



One left
castle support



One **SmartPoint**[®]
elevator platform



One left wall



One gate arm



One castle
back support



One pickup window



One takeout bag



One **SmartPoint**[®]
main track



One castle

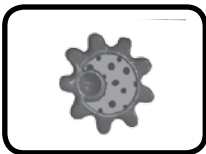

One big gear



One small gear



One track support



One slide track



Two 90-degree bulge tracks



Three 1/3 length bulge tracks



One **SmartPoint**[®] castle floor



One standard-length track



One castle door



One platform support



One label sheet

- One Quick Start Guide

WARNING

All packing materials such as tape, plastic sheets, packaging locks, removable tags, cable ties, cords and packaging screws are not part of this toy and should be discarded for your child's safety.

NOTE

Please save this Instruction Manual as it contains important information.

ATTENTION

Pour la sécurité de votre enfant, débarrassez-vous de tous les produits d'emballage tels que rubans adhésifs, feuilles de plastique, attaches, étiquettes, cordons et vis d'emballage. Ils ne font pas partie du jouet.

NOTE

Il est conseillé de conserver ce guide des parents car il comporte des informations importantes.

Adult assembly required.

Ce jouet doit être assemblé par un adulte.

Unlock the Packaging Locks

- ① Turn the packaging locks counterclockwise several times.
- ② Pull out the packaging locks and discard.

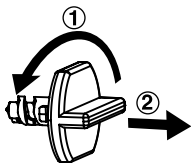

GETTING STARTED

Battery Removal and Installation

Food Truck

1. Make sure the unit is turned **Off**.
2. Find the battery cover located on the bottom of the unit, use a coin or screwdriver to loosen the screw and then open the battery cover.
3. Remove old batteries by pulling up on one end of each battery.

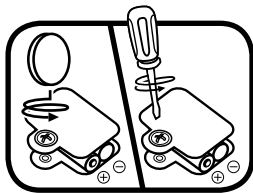

4. Install 2 new AAA (AM-4/LR03) batteries following the diagram inside the battery box. (For best performance, alkaline batteries or fully charged Ni-MH rechargeable batteries are recommended).
5. Replace the battery cover and tighten the screw to secure.



WARNING:

Adult assembly required for battery installation.
Keep batteries out of reach of children.



ATTENTION :

Les piles ou accumulateurs doivent être installés par un adulte.
Tenir les piles ou accumulateurs hors de portée des enfants.

IMPORTANT: BATTERY INFORMATION

- Insert batteries with the correct polarity (+ and -).
- Do not mix old and new batteries.
- Do not mix alkaline, standard (carbon-zinc) or rechargeable batteries.
- Only batteries of the same or equivalent type as recommended are to be used.
- Do not short-circuit the supply terminals.
- Remove batteries during long periods of non-use.
- Remove exhausted batteries from the toy.
- Dispose of batteries safely. Do not dispose of batteries in fire.

RECHARGEABLE BATTERIES

- Remove rechargeable batteries from the toy before charging.
- Rechargeable batteries are only to be charged under adult supervision.
- Do not charge non-rechargeable batteries.

LABEL APPLICATION

Please securely stick the labels to the playset as indicated below:

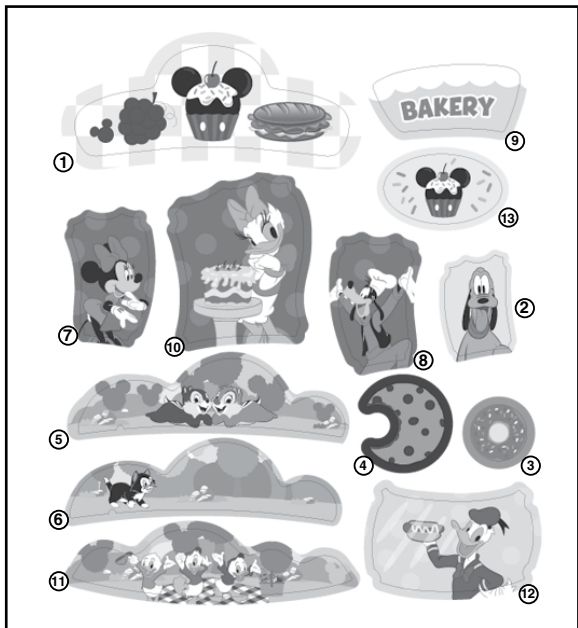

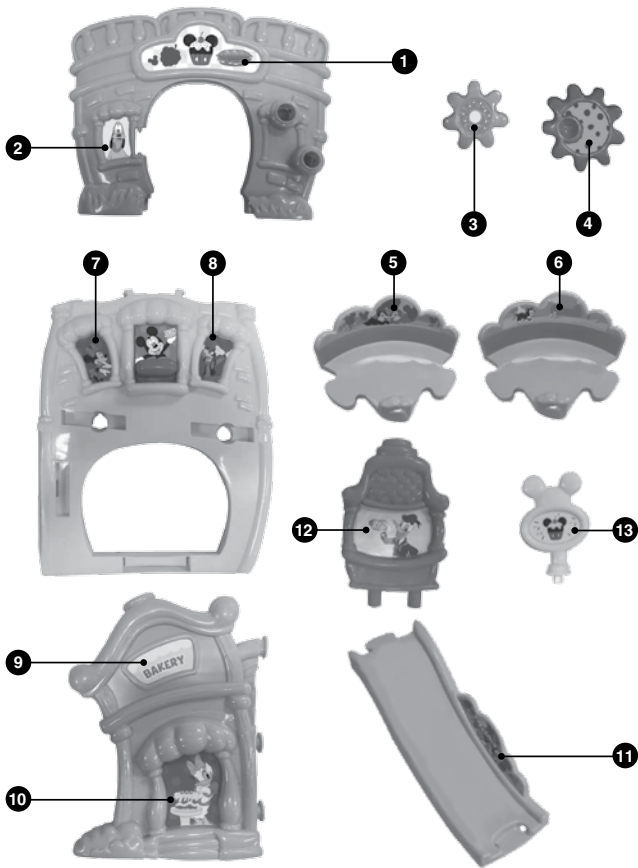

ASSEMBLY INSTRUCTIONS

Mickey Mouse Café

With the **Go! Go! Smart Wheels® - Disney Mickey Mouse Café**, safety comes first. To ensure your child's safety, adult assembly is required.

1. Attach the **Castle Door** onto the front wall of the **Castle**. Then, attach both the **Big Gear** and the **Small Gear** onto the right side of the front wall. A click sound will indicate the pieces are secure.

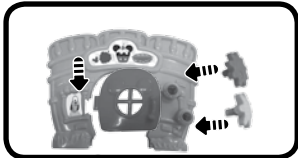

2. Attach the **SmartPoint® Main Track** into the slots on the front side of the **Castle Back Support**. A click sound will indicate the pieces are secure.

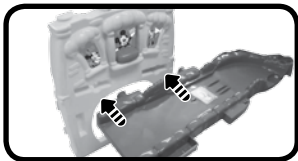

3. Set the **Castle Back Support** on its side. Insert the **Left Wall** into the slot on the left side of the **Castle Back Support**, beneath the **SmartPoint® Main Track**.

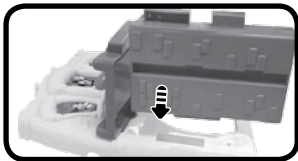

4. Turn the structure upright again and attach the **Track Support** beneath the right side of the **SmartPoint® Main Track**.

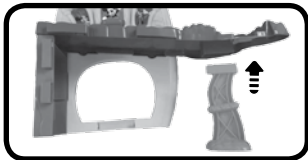

5. Connect the pegs on the **Left Wall** and the **SmartPoint® Main Track** to the slots on the back of the **Castle**.

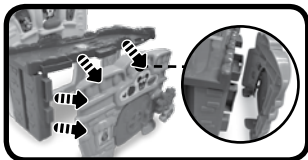

6. Connect the **SmartPoint® Castle Floor** under the structure.

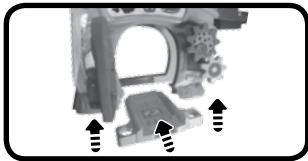

7. Attach the **Platform Support** to the **Left Wall**.

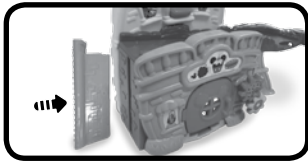

8. Attach the **Left Castle Support** to the **Castle Back Support**.

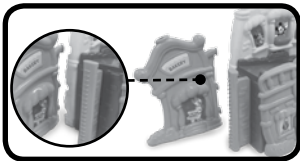

9. Attach the **Castle Roof** to the top of the **Castle Back Support**.

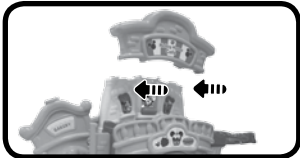

10. Connect the **SmartPoint® Elevator Platform** to the bottom of the **Platform Support**.



11. Connect the **Standard-Length Track** to the front of the **SmartPoint® Castle Floor**.

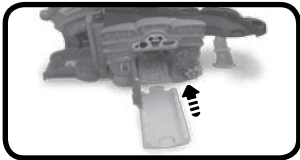

12. Link the other tracks to the **Standard-Length Track** in the following order: **1/3 Length Bulge Track**, **90-Degree Bulge Track**, **two 1/3 Length Bulge Tracks**, **90-Degree Bulge Track**.



13. Use the **Slide Track** to link the **SmartPoint® Main Track** to the second level with the **90 Degree Bulge Track** on the first level.

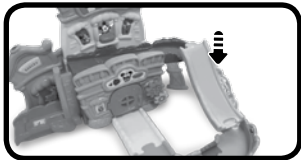

14. Insert the **Rotary Sign** into the top of the **Left Castle Support**.

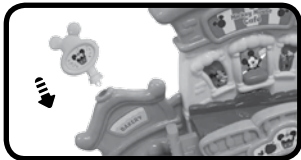

15. Attach the **Gate Arm** to the right side of the **SmartPoint® Main Track**. A click sound will indicate the pieces are secure.



16. Attach the **Pickup Window** next to the **Gate Arm** and attach the **Takeout Bag** to the top of the **Pickup Window**.



17. Insert the **Chef's Hat** into the top of the **Castle Roof**.

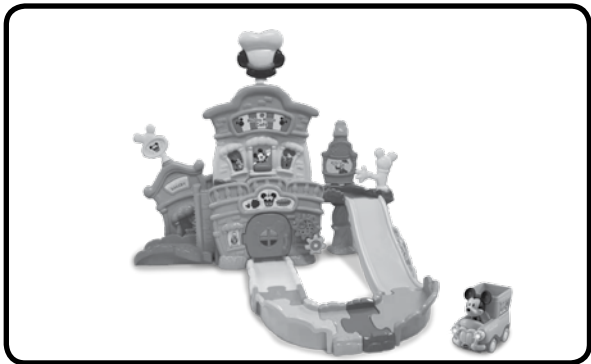
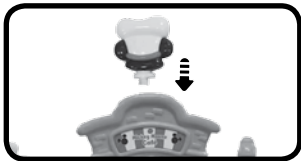



Once you've completed the above steps, you are ready to play! You can connect these pieces to other **Go! Go! Smart Wheels®** playsets and tracks (each sold separately).

PRODUCT FEATURES

Mickey Mouse Food Truck

1. On/Off Switch

To turn the **Food Truck On**, slide the **On/Off Switch** to the **On**  position. To turn the **Food Truck Off**, slide the **On/Off Switch** to the **Off**  position.

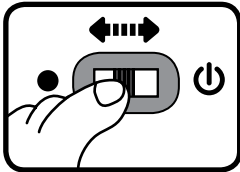

2. Automatic Shut-Off

To preserve battery life, the **Food Truck** will automatically power-down after approximately 60 seconds without input. The unit can be turned on again by pressing **Mickey Mouse**, pushing the **Food Truck** quickly or triggering a **SmartPoint®** location.

Note: This product is in Try-Me mode in the packaging. After opening the package, turn the **Food Truck Off** and **On** again to proceed with normal play. If the unit powers down while playing, we suggest changing the batteries.

ACTIVITIES

Food Truck

1. Character Button

Press **Mickey Mouse** to hear fun phrases, songs, sounds and melodies. The lights will flash with sounds.

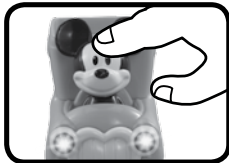

2. Sounds and Melodies

Push the **Food Truck** to hear fun sounds and phrases. While a melody is playing, continue pushing the **Food Truck** to add in fun sounds on top of the melody. The lights will flash with sounds.

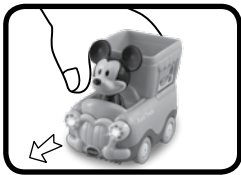

3. SmartPoint® Locations

For added fun, the **Food Truck** interacts with the **Go! Go! Smart Wheels® - Disney Mickey Mouse Café**. Simply place the **Food Truck** on one of the playset's three **SmartPoint®** locations to see the **Food Truck** lights flash and hear fun sounds, short tunes and phrases. The **Food Truck** even interacts with other **Go! Go! Smart Wheels®** playsets (sold separately).



ACTIVITIES

Mickey Mouse Café

1. Elevator

Put the **Food Truck** on the **SmartPoint® Elevator Platform** and then move the **Elevator** up and down.

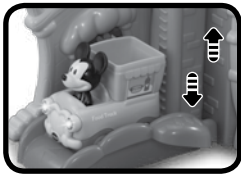

2. Gate

Turn the **Gate Arm** on the second floor to send the **Food Truck** down the **Slide Track**.

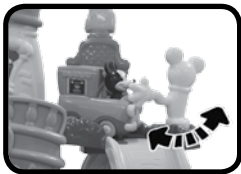

3. Castle Door

Open the **Castle Door** and push the **Food Truck** through the tunnel for role-play fun.



4. Motor Skills

Turn the **Big** and **Small Gears** on the **Castle**, open and close the windows to see Mickey Mouse and friends, or twist the **Rotary Sign** and **Chef's Hat** on the top of the **Castle** for more tactile stimulation.



5. Pickup Window

Remove the **Takeout Bag** from the top of the **Pickup Window** and place it in the bed of the **Food Truck** for more pretend play.



SONG LYRICS

Song 1

Load up my truck, all the food is to go
There's no time to waste, so let's hit the road
Delivering smiles and saying hello
To all the friends we meet as we go!

Song 2

Hey there, are you hungry?
I can cook you up something!

Song 3

My food truck is on the way,
On the way, on the way
My food truck is on the way,
Delivering meals today

MELODY LIST

1. Looby Loo
2. Do You Know the Muffin Man?
3. Pat-a-Cake
4. Dill Pickles Rag
5. Diddle, Diddle, Dumpling, My Son John
6. Hot Cross Buns

CARE & MAINTENANCE

1. Keep the unit clean by wiping it with a slightly damp cloth.
2. Keep the unit out of direct sunlight and away from any direct heat sources.
3. Remove the batteries when the unit will not be in use for an extended period of time.
4. Do not drop the unit on hard surfaces and do not expose the unit to moisture or water.

TROUBLESHOOTING

If for some reason the unit stops working, please follow these steps:

1. Please turn the unit **Off**.
2. Interrupt the power supply by removing the batteries.
3. Let the unit sit for a few minutes, then replace the batteries.
4. Turn the unit **On**. The unit should now be ready to play again.
5. If the product still does not work, replace with an entire set of new batteries.

IMPORTANT NOTE:

If the problem persists, please call our **Consumer Services Department** at **1-800-521-2010** in the U.S., **1-877-352-8697** in Canada, or by going to our website **vtechkids.com** and filling out our **Contact Us** form located under the **Customer Support** link. Creating and developing VTech products is accompanied by a responsibility that we take very seriously. We make every effort to ensure the accuracy of the information, which forms the value of our products. However, errors sometimes can occur. It is important for you to know that we stand behind our products and encourage you to contact us with any problems and/or suggestions you might have. A service representative will be happy to help you.

Note

This equipment has been tested and found to comply with the limits for a Class B digital device, pursuant to Part 15 of the FCC Rules. These limits are designed to provide reasonable protection against harmful interference in a residential installation. This equipment generates, uses and can radiate radio frequency energy and, if not installed and used in accordance with the instructions, may cause harmful interference to radio communications. However, there is no guarantee that interference will not occur in a particular installation. If this equipment does cause harmful interference to radio or television reception, which can be determined by turning the equipment off and on, the user is encouraged to try to correct the interference by one or more of the following measures:

- Reorient or relocate the receiving antenna.
- Increase the separation between the equipment and receiver.
- Connect the equipment into an outlet on a circuit different from that to which the receiver is connected.
- Consult the dealer or an experienced radio/TV technician for help.

Caution: Changes or modifications not expressly approved by the party responsible for compliance could void the user's authority to operate the equipment.

Supplier's Declaration of Conformity
47 CFR § 2.1077 Compliance Information

Trade Name: VTech®
Model: 5439
Product Name: Go! Go! Smart Wheels®
Disney Mickey Mouse Café
Responsible Party: VTech Electronics North America, L.L.C.
Address: 1156 W. Shure Drive, Suite 200,
Arlington Heights, IL 60004
Website: vtechkids.com

THIS DEVICE COMPLIES WITH PART 15 OF THE FCC RULES. OPERATION IS SUBJECT TO THE FOLLOWING TWO CONDITIONS: (1) THIS DEVICE MAY NOT CAUSE HARMFUL INTERFERENCE, AND (2) THIS DEVICE MUST ACCEPT ANY INTERFERENCE RECEIVED, INCLUDING INTERFERENCE THAT MAY CAUSE UNDESIRED OPERATION.

CAN ICES-003(B)/NMB-003(B)

**Visit our website for more
information about our products,
downloads, resources and more.**

vtechkids.com
vtechkids.ca

Read our complete warranty policy online at
vtechkids.com/warranty
vtechkids.ca/warranty

